

N64™ Rumble Pak™ Instruction Booklet



Thank you for purchasing the Nintendo 64 Rumble Pak accessory for the Nintendo 64 system. Before using the N64 Rumble Pak, first read this instruction booklet and the instruction booklet for the Game Pak you are using. If, after reading the instructions and precautions, and you have questions on using the Rumble Pak or the N64 system, please call the Consumer Assistance Hotline at the telephone number listed below.

***NEED HELP WITH INSTALLATION,
MAINTENANCE OR SERVICE?***



***AUTHORIZED REPAIR CENTERS™
1-800-255-3700***

MON. - SAT., 6:00 a.m. to 9:00 p.m.; SUN., 6:00 a.m. to 7:00 p.m., Pacific Time
(Times subject to change)

Emulation64.fr



⚠ WARNING

PLEASE CAREFULLY READ THE CONSUMER INFORMATION AND PRECAUTIONS BOOKLET INCLUDED WITH THIS PRODUCT BEFORE USING YOUR NINTENDO HARDWARE SYSTEM, GAME PAK OR ACCESSORY. THIS BOOKLET CONTAINS IMPORTANT SAFETY INFORMATION.

N64 RUMBLE PAK™ ACCESSORY

The N64 Rumble Pak is an accessory for the N64 Controller. It allows the player to experience real-time feedback from games that have been specifically designed to use the Rumble Pak.

The N64 Rumble Pak Accessory will operate only with Nintendo 64 Game Paks displaying the N64 Rumble Pak icon. Look for this icon to ensure compatibility with this accessory.



Important: The Rumble Pak does not have the ability to save or download game play data. Consult the instruction booklet for the Game Pak you are using for further information on game play with your Rumble Pak accessory or Controller Pak.

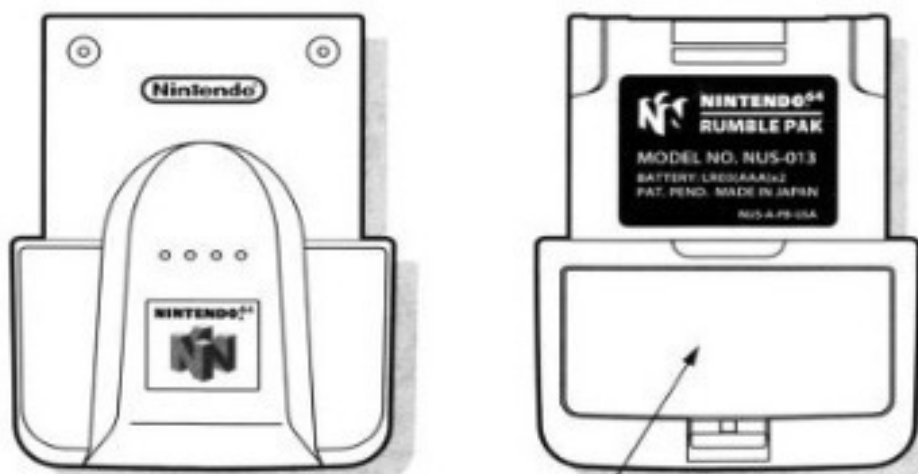

Battery Cover

TM, ® and the "N" logo are trademarks of Nintendo of America Inc.
©1997 Nintendo of America Inc.

Emulation64.fr



N64 RUMBLE PAK OPERATION

After completing the setup for the N64 Control Deck, Controller and Game Pak as shown in the N64 Instruction Booklet, continue with the following instructions:

1. Remove the battery cover on the back of the Rumble Pak and insert two AAA batteries as shown in Illustration 1. Make sure to use only fresh alkaline batteries. **Do not use nickel-cadmium batteries (rechargeable type).**

Caution: When inserting the batteries, make sure that the positive (+) and negative (-) ends are facing in the correct directions (see illustration 1).

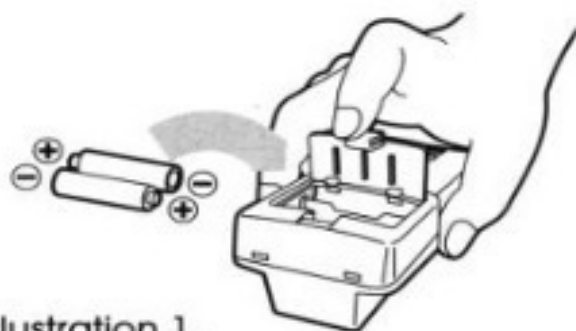

Illustration 1.

When the power is low, the vibrations from the Rumble Pak will become weak. When this happens, replace the batteries with two fresh ones immediately. Leaving used batteries in the Rumble Pak may result in damage to the unit.

2. Make sure the Power Switch of the Control Deck is turned **OFF** when inserting or removing the Rumble Pak.

CAUTION

ALWAYS CHECK THE N64 RUMBLE PAK EDGE CONNECTOR FOR FOREIGN MATERIAL (WHICH CAN DAMAGE THE CONTROLLER) BEFORE ATTEMPTING TO LOAD THE N64 RUMBLE PAK INTO THE CONTROLLER.

3. Load the Rumble Pak so that it is fully inserted into the connector on the bottom of the Controller as shown in Illustration 2. The Rumble Pak will "click" into place when fully inserted.



Illustration 2.
Emulation64.fr



4. To remove the Rumble Pak from the Controller, turn the Power Switch of the Control Deck OFF.

Press and hold the lock release button on the bottom of the Controller while removing the Rumble Pak from the Controller as shown in Illustration 3.

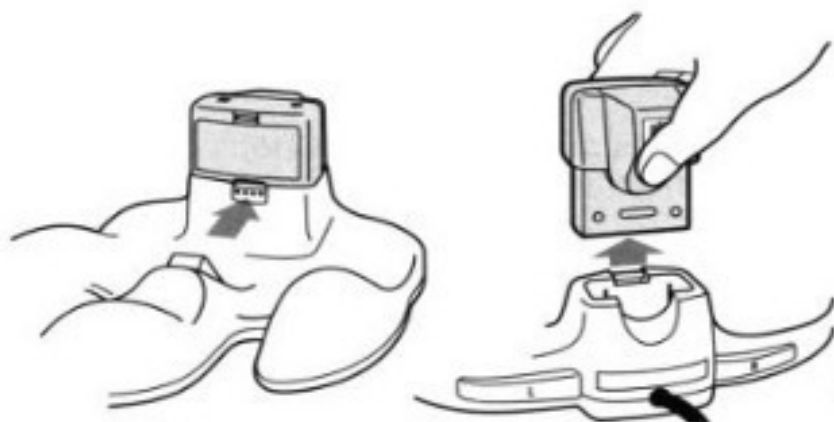

Illustration 3.

BATTERY PRECAUTIONS/WARNING



FAILURE TO FOLLOW THE FOLLOWING INSTRUCTIONS MAY CAUSE THE BATTERIES TO MAKE "POPPING" SOUNDS AND LEAK BATTERY ACID RESULTING IN PERSONAL INJURY AND DAMAGE TO YOUR RUMBLE PAK OR N64 CONTROLLER. IF BATTERY LEAKAGE OCCURS, THOROUGHLY WASH THE AFFECTED SKIN AND CLOTHES. KEEP BATTERY ACID AWAY FROM YOUR EYES AND MOUTH. CONTACT THE BATTERY MANUFACTURER FOR FURTHER INFORMATION.

1. Do not mix used and new batteries (replace all batteries at the same time).
2. Do not mix battery types (do not mix alkaline and carbon zinc batteries or mix different brands of batteries).
3. Do not put the batteries in backwards (positive (+) and negative (-) ends must face the proper direction).
4. Do not leave used batteries in the Rumble Pak. When the batteries are losing their charge, the vibration of the Rumble Pak may become weak or stop. When this happens, promptly replace all used batteries with fresh batteries.
5. Do not leave batteries in the Rumble Pak for long periods of non-use.
6. Do not dispose of batteries in a fire. Do not recharge the batteries.
7. Do not use nickel-cadmium batteries (rechargeable type).



TROUBLE SHOOTING GUIDE

Before seeking repair service, please check that the problem is not listed below.

PROBLEM	CAUSE	SOLUTION
Rumble Pak does not vibrate.	No batteries.	Load batteries.
	Batteries have run out.	Replace with fresh batteries.
	Batteries are inserted incorrectly.	Check orientation of batteries.
	Rumble Pak not inserted all the way.	Re-insert Rumble Pak, making sure it "clicks" into place.
	Controller or Rumble Pak connectors are dirty or contaminated with foreign material.	Check connectors for foreign material and remove if necessary.
	Game Pak is not designed for use with the Rumble Pak.	Use a Rumble Pak compatible Game Pak.
Rumble Pak vibration is weak.	Batteries are running out.	Replace with fresh batteries.
Rumble Pak won't stop vibrating.	Controller or Rumble Pak connectors are dirty or contaminated with foreign material.	Check connectors for foreign material and remove if necessary.

If you are still unable to solve the problem, please call the Consumer Assistance Hotline at 1-800-255-3700.

If you would like to order an N64 Rumble Pak accessory, a replacement battery cover or other Nintendo parts, please call the Consumer Assistance Hotline at 1-800-255-3700.



Nintendo - N64 Rumble Pak

This official seal is your assurance that Nintendo has reviewed this product and that it has met our standards for excellence in workmanship, reliability and entertainment value. Always look for this seal when buying games and accessories to ensure complete compatibility with your Nintendo product.

All Nintendo products are licensed by sale for use only with other authorized products bearing the Official Nintendo Seal of Quality®.



Nintendo®

Nintendo of America Inc.
P.O. Box 957, Redmond, WA 98073-0957 U.S.A.

Emulation64.fr

